

METAL SEATED GATE VALVE, PN16, DN 700-1000**54/3132/A**
003

Metal seated gate valve, designed according to EN1074 part 1 & 2, Face to face according to EN 558 table 2 basic series 3.
Standard flange drilling to EN1092-2 (ISO 7005-2)

Use: For water, sewage and neutral liquids to max. 70°C
Hydraulic tests: Seat: 1.1 x PN Body: 17 bar (PN 10), 25 bar (PN 16)
Applicable Standards: To EN 1074 part 1 & 2 : 2000 (BS 5163: 1986 type B)
Flange drilling to EN 1092-2: PN 10 or PN 16
Options: Handwheel
Electric Actuation
Bevel or Spur Gearboxes
Bypass
Alternative Trim Materials
Jacking screw
Inspection cover
Rising Stem
PN 25 Version

Valves must not be operated without a gearbox or actuator. Thrust is taken in the gearbox or actuator.

Ref. numbers shown relate to the standard ISO mounting flange. For differential pressures of 10 bar and above, the mounting flange and Ref. number may change.

Materials:

Body	Ductile Iron EN 1563 EN-GJS-500/7
Bonnet	Ductile Iron EN 1563 EN-GJS-500/7
Wedge	Ductile Iron EN 1563 EN-GJS-500/7
Stem Cap	Ductile Iron EN 1563 EN-GJS-500/7
ISO top flange	Ductile Iron EN 1563 EN-GJS-500/7
Seats/Faces	Al Bronze EN 1982 CC331G (AB1)
Wedge Nut	Al Bronze EN 1982 CC331G (AB1)
Thrust Collars	Al Bronze EN 1982 CC331G (AB1)
Stem	Stainless Steel EN 10088 No 1.4057
Key	Carbon Steel BS 4235 Part 1
Plug	Brass EN 12165: CW602N
O-Rings	EPDM
Gasket	Nylon
Fasteners	Zinc plated mild steel
Coating	DN 700-900: Internal and external blue fusion bonded epoxy. DN 1000-1200: Internal and external blue two pack epoxy.



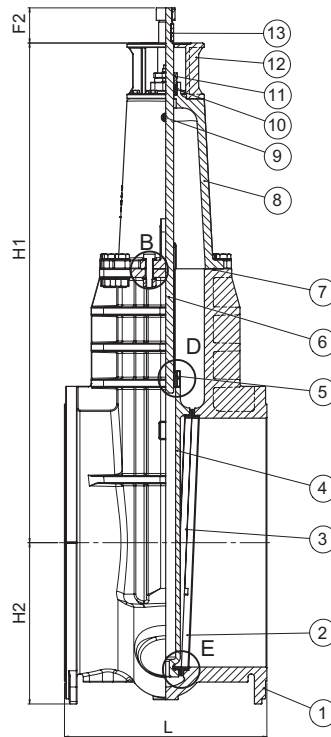
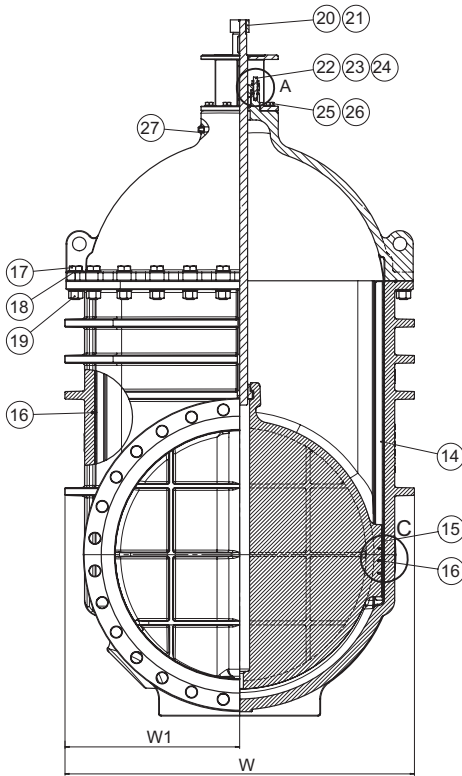

A. Stem sealing

O-ring stem sealing comprising of 4 O-rings to ensure optimum sealing through stem.

B. Body/bonnet connection

The unique assembly of the valve body and bonnet ensures a durable tightness: A round rubber bonnet gasket fits into a recess in the valve body preventing it from being blown out by pressure surges.

C. Shoes and channel

Shoes and Channels are manufactured from Gunmetal and help to reduce friction between the wedge and body during operation. Accurate alignment is also achieved. Shoes and Channels are necessary when horizontal installation of the valve is required.

D. Wedge nut

The wedge nut is made of bronze with lubricating abilities providing optimum compatibility with the stainless steel stem.

E. Outlet

The wedge is made from ductile iron with bronze face rings which are machined to a fine surface finish to ensure optimum contact seal with body seat rings. The wedge face rings are accurately machined and firmly secured to the wedge. The guides in the wedge ensure uniform closure regardless of high pressures. The wedge has a large through bore housing the stem that ensures no stagnant water or impurities can collect.

Component list

1. Body	2. Seat Ring
3. Face Ring	4. Wedge
5. Stem Nut	6. Stem
7. O-Cord	8. Bonnet
9. Plug	10. Packing
11. Gland	12. Distance Piece
13. Key	14. Channel (shoes & channel optional)
15. Shoe(shoes & channel optional)	16. Countersunk screw (shoes & channel optional)
17. Hex Bolt	18. Washer
19. Nut	20. Thrust Nut
21. Grub Screw	22. Stud Bolt
23. Nut	24. Washer
25. Hex Screw	26. Washer
27. Gasket	

Reference nos. and dimensions

AVK ref. nos.	DN mm	Closing dir.	L mm	H1 mm	H2 mm	W mm	W1 mm	F2 mm	ISO flange	Theoretical weight kg
54-0700-31-0101100	700	CTC	610	1497	450	1050	524	116	14	1416
54-0700-31-0101101 #)	700	CTC	610	1497	450	1050	524	116	14	1429
54-0700-32-0101101 #)	700	CTO	610	1497	450	1050	524	116	14	1429
54-0700-32-1101101 #)	700	CTO	610	1497	450	1050	524	116	14	1429
54-0800-31-0101101 #)	800	CTC	660	1689	535	1160	580	116	14	1779
54-0800-32-0101101 #)	800	CTO	660	1689	535	1160	580	116	14	1779
54-0800-32-1101101 #)	800	CTO	660	1689	535	1160	580	116	14	1779
54-0900-31-0102101 #)	900	CTC	711	1844	596	1304	655	131	16	2330
54-0900-31-1102101 #)	900	CTC	711	1844	596	1304	655	131	16	2330
54-0900-32-0102101 #)	900	CTO	711	1844	596	1304	655	131	16	2330
54-0900-32-1102101 #)	900	CTO	711	1844	596	1310	655	131	16	2330
54-1000-31-0102101 #)	1000	CTC	813	2007	648	1404	702	136	16	3072
54-1000-32-0102101 #)	1000	CTO	813	2007	648	1394	702	136	16	3072
54-1000-32-1102101 #)	1000	CTO	813	2007	648	1394	702	136	16	3072

Shoes & channels