

# Modular transfer plates

## Part. 257 Modular transfer plates with rollers (width 115 mm 5 rows of rollers)

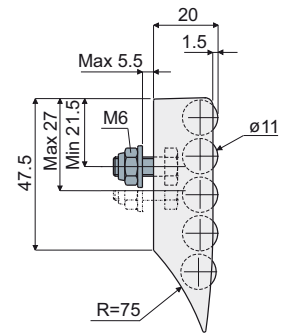
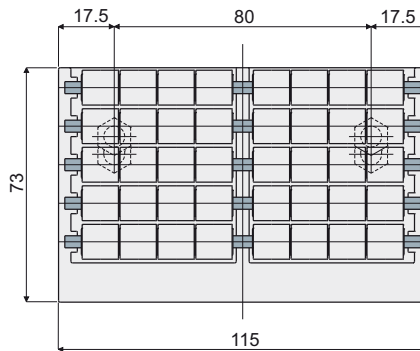

Code  
257 / 82005

**MATERIALS:** Modular transfer plate with external module and rollers made of acetal grey colour; pins and fixing bolts and nuts made of stainless steel AISI 304.  
**FEATURES:** To be assembled at the end of your conveyor to help the products transfer. Easy to assemble, low friction coefficient, minimum noise level, extremely cleanable.

**BOX QUANTITY:** 8 pieces.

**ON REQUEST:**

- External module and rollers: Can be produced in other colours.
- Box Quantity: According to your request.

## Part. 258 Modular transfer plates with rollers (width 115 mm 3 rows of rollers)

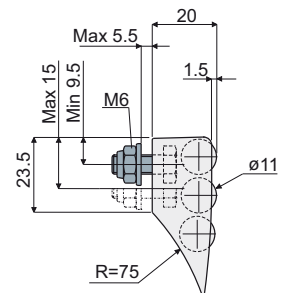
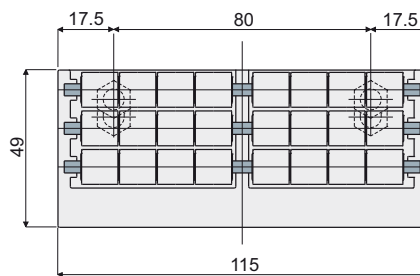

Code  
258 / 82004

**MATERIALS:** Modular transfer plate with external module and rollers made of acetal grey colour; pins and fixing bolts and nuts made of stainless steel AISI 304.  
**FEATURES:** To be assembled at the end of your conveyor to help the products transfer. Easy to assemble, low friction coefficient, minimum noise level, extremely cleanable.

**BOX QUANTITY:** 8 pieces.

**ON REQUEST:**

- External module and rollers: Can be produced in other colours.
- Box Quantity: According to your request.

## Part. 259 Modular transfer plates with rollers (width 115 mm 2 rows of rollers)

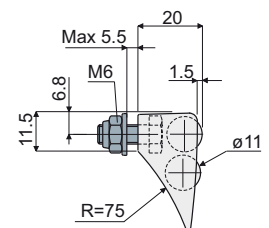
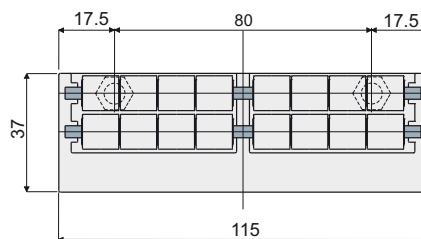

Code  
259 / 82003

**MATERIALS:** Modular transfer plate with external module and rollers made of acetal grey colour; pins and fixing bolts and nuts made of stainless steel AISI 304.  
**FEATURES:** To be assembled at the end of your conveyor to help the products transfer. Easy to assemble, low friction coefficient, minimum noise level, extremely cleanable.

**BOX QUANTITY:** 8 pieces.

**ON REQUEST:**

- External module and rollers: Can be produced in other colours.
- Box Quantity: According to your request.